

SCIENCE MUSEUM

THE SECRET LIFE
OF THE HOME
30 MAY 2018
18.45-22.00
#SMLATES

LATES

18

1

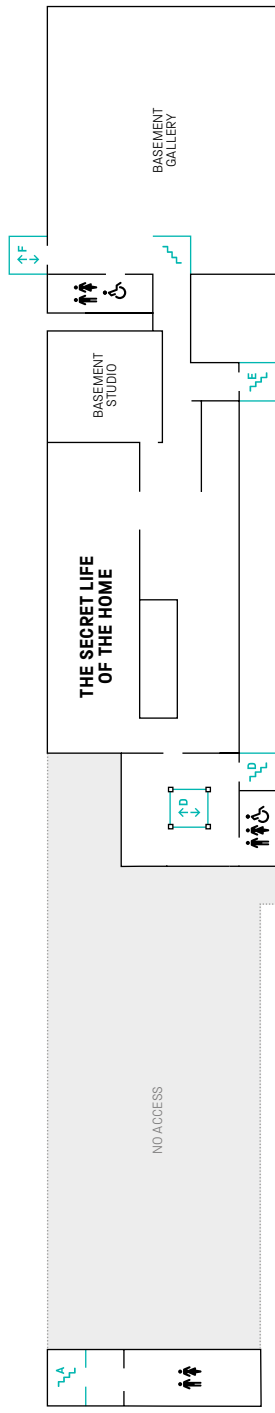
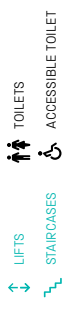

PERFORMANCE TALK

HOARD AS HOME: CLUTTER AS COMFORT

BASEMENT STUDIO

19.30–20.00, 21.00–21.30

Artist Zoë Mendelson uses fiction, animation and research in the medical humanities to explore the contested borders of collection and hoarding. These performances will challenge your views of what makes a lived-in home.

TALK

THE FRIDGE

BASEMENT STUDIO

20.15–20.45

Join curator Helen Peavitt as she delves to the back of your fridge to tell you more about where these extraordinary technological contraptions have come from and the dirty stuff we do with them.

WORKSHOP

LIFE HACK CRAFTS

BASEMENT GALLERY

18.45–21.30 (DROP IN)

Come and try the hacks you've seen online to see if they really work for you and your craftastic home.



INTERACTIVE WORKSHOP

HEALTHY KITCHEN, HEALTHY HOME

BASEMENT GALLERY

18.45–21.30 (DROP IN)

Food safety officers will show you where there are unknown hazards in the kitchen. You'll never look at your kitchen in the same way again!

DROP IN

FIRE SAFETY WITH THE BRIGADE

BASEMENT GALLERY

18.45–21.30

Do you have an escape route? Do all your detectors work? How safe would you be in a fire in your home? Talk to the experts at the London Fire Brigade.

O

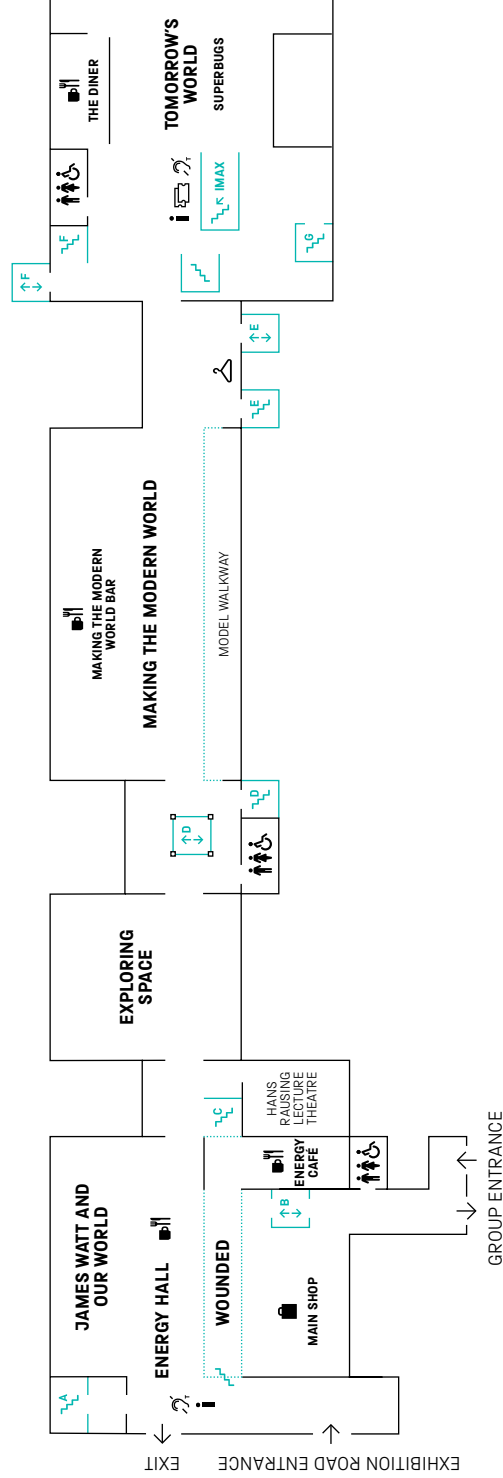

TOUR

HIGHLIGHTS TOUR

MEET AT THE INFORMATION DESK
19.00–20.00

Follow one of our Volunteer Tour Guides on a whistle-stop tour of some of our most beloved iconic objects and discover the untold stories they hold.

TOUR

WOUNDED TOUR

MEET AT THE INFORMATION DESK
19.30–20.00, 20.30–21.00

Join our Volunteer Tour Guides as they bring the Wounded Exhibition to life with in depth knowledge and fascinating tales. One of the last chances to see this gallery.



TOUR

BEHIND-THE-SCENES TOUR

MEET AT THE INFORMATION DESK
19.15–19.45, 20.00–20.30, 20.45–21.15

Come and see where we treat and care for the museum's collection of weird and wonderful objects. Find out what creatures dwell here as well in your homes. Please book at the Information desk.

Places very limited.

DANCE

SILENT DISCO

EXPLORING SPACE
18.45–21.40 (DROP IN)

Whether you're practising your moves or just in the mood to slam dunk the funk, grab a headset, select your tunes and dance until you drop.

Entry £2 per person – tickets available in the Exploring Space gallery. Last entrance 21.30.

TALK

THE INVENTION OF NATURE

HANS RAUSING LECTURE THEATRE
19.30–20.30

Find out more about the visionary German naturalist Alexander von Humboldt (1769–1859) with Andrea Wuif's latest book. *The Invention of Nature* reveals Humboldt's extraordinary life and how he created the way we understand nature today. A presentation from Andrea is followed by a conversation about Humboldt's life and work with science journalist Gaia Vince. *£5 per person – tickets available at any ticket desk.*
There will be a book signing at 20.30.

O



THE DINER

FOOD + DRINK



ENERGY CAFÉ + GIN BAR

Enjoy one of our stone-baked pizzas handmade to order. We also have panzerotti, arancini and macaroni cheese. Plus a selection of sandwiches, salads, snacks and treats. Love gin? Then look no further. Come and enjoy our gin-based cocktails themed for the occasion. A range of premium gins are also available, as well as beer and cider.

ENERGY HALL BAR

CASH ONLY

Your first stop for a thirst-quenching London lager or pale ale. Ciders, wines and soft drinks available too.

MAKING THE MODERN WORLD BAR

This street food stall serves tasty barbecue Buffalo wings and falafel pittas with freshly made slaw. Chips and dips are available for those who prefer a light snack. We also have a fully stocked bar to quench your thirst.

THE DINER

Have a beer or glass of wine while you explore the Wellcome Wing. Mixed nuts and nibbles are available too.

1

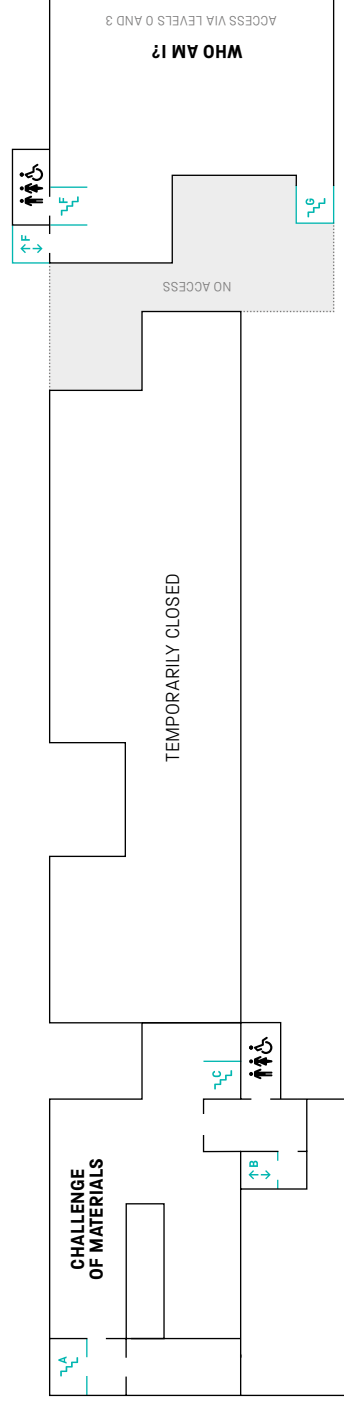
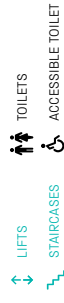

DROP IN

TEENAGE BEDROOMS

CHALLENGE OF MATERIALS
18.45–21.30 (DROP IN)

At Queen Mary, University of London, Carey Newson has been researching how teenage bedrooms shape our identity. Join in and share your memories of your tidy or depraved dwelling during your pubescent years.

WORKSHOP

PARKLIFE: A GAME OF COLLECTIVE ACTION

WHO AM I?
19.45–20.00, 20.05–20.20, 20.25–20.40,
20.45–21.00, 21.05–21.20, 21.25–21.40

Play Parklife, a game for two teams working together and against each other to build the best virtual London park. With this short game we're investigating the psychology of cooperation and competition.

COMPETITION TIME

WIN A VIP LATES EXPERIENCE FOR YOU AND THREE FRIENDS AT ONE OF OUR FUTURE LATES

Jump the queue with our VIP entrance and enjoy a free drink each on us. Also included in the prize are:

- Four tickets to a simulator
- A Science Museum goody bag
- Free access to the silent disco

To enter the competition please visit sciencemuseum.org.uk/latescomp

2

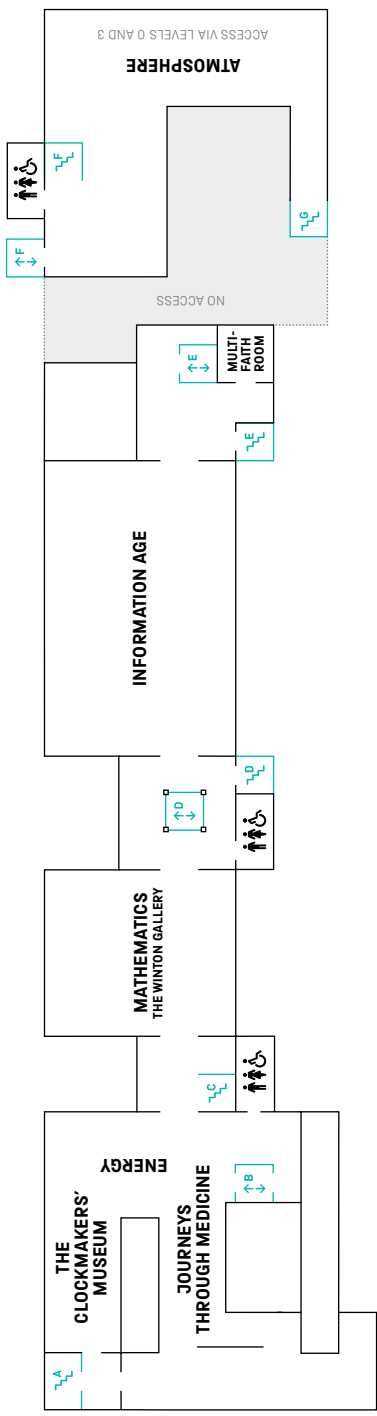

INTERACTIVE TALK

MIGRATION

MATHEMATICS: THE WINTON GALLERY
19.30–20.00, 20.15–20.45, 21.00–21.30

Find out what a group of researchers at Queen Mary, University of London, have discovered when looking at migration, from the movement of people around the world to the ways city populations shift.

MUSEUM COLLECTION

HIDDEN GEMS

INFORMATION AGE
18.45–21.30 (DROP IN)

Get close to rarities from our collection and meet the Science Museum's expert curators and some of their favourite objects.

MUSEUM COLLECTION

CAN TOUCH THIS

INFORMATION AGE
18.45–21.30 (DROP IN)

Hold history in your hands with objects from the Science Museum's collection. Museum volunteers will show you what they are made from and how they transformed the way we communicate and share information.

DROP IN

MEET THE PLUMBER

INFORMATION AGE
18.45–21.30 (DROP IN)

Do you have any urgent plumbing questions? Or would you just like to hone your plumbing skills? Pop along to meet a plumber and learn a thing or two.

DROP IN

MEET THE ELECTRICIAN

INFORMATION AGE
18.45–21.30 (DROP IN)

Do you have any burning electrical questions? Or would you just like to power up your wiring skills? Zip along to meet an electrician and learn a thing or two.



WORKSHOP

SCREEN GRAB

INFORMATION AGE
18.45–21.30 (DROP IN)

Join two up-and-coming printmakers in their pop-up studio and create your own screen-print souvenir of this month's Lates. It will be hands-on, beautiful and inky...

DRAMA

THOMAS EDISON

INFORMATION AGE
19.30–20.00, 20.15–20.45, 21.00–21.30

Meet Thomas and hear about his inventions, light bulbs, video cameras and so much more.

3

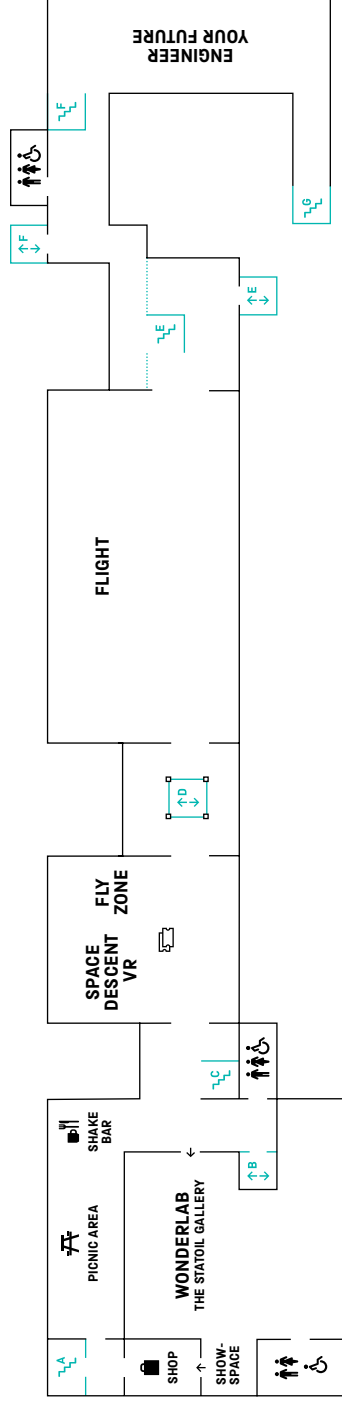

TALK

PLUCKED! THE TRUTH ABOUT CHICKEN

WONDERLAB SHOWSPACE

19.30-20.00, 20.15-20.45, 21.00-21.30

How did we get the meat we eat today? Maryn McKenna examines how chickens hatched the modern food system. So many problems, from antibiotics to animal welfare problems, environmental threats to overprocessed protein, trace back to chicken – but now there's hope for change.

There will be a book signing after the 20.15 talk.

INTERACTIVE GALLERY

WONDERLAB: THE STATOIL GALLERY

18.45-21.30

Fuel your imagination and immerse yourself in a world of wonder at the most spectacular interactive science gallery in the world. With 50 mind-blowing marvels of science to enjoy, *Wonderlab* is an experience unlike any other. *Special Lates price – only £5!*

WORKSHOP

BOX BOT

PICNIC AREA

18.45-21.30 (DROP IN)

Make your own personalised moving robot box. Pick up some circuitry knowledge along the way and impress your friends with your soldering skills.

£2 per kit – available in the picnic area.

TALK

HOUSE PETS AND HOME PESTS

FLIGHT

19.30-20.00, 20.15-20.45, 21.00-21.30

Take a first-hand look at some of the animals living with you at home including a few welcome guests, such as popular pets, as well as a few not-so-welcome visitors. But are these uninvited guests all so bad? Get hands-on with snails, cockroaches and snakes!

VR EXPERIENCE

SPACE DESCENT VR WITH TIM PEAKE

FLY ZONE

18.45-21.30 (DROP IN)

Embark on an out-of-this-world virtual reality mission and experience the thrill of being an astronaut. With Tim Peake as your guide, retrace the 400km high-speed journey back to Earth from the International Space Station.

Lates special offer – 35% off standard admission.

SIMULATOR

FLY WITH THE RED ARROWS IN FLY ZONE

19.15-21.10

Discover the thrill of flying in the cockpit of a Red Arrows jet in our breathtaking Red Arrows 3D flight simulation theatre.

Half-price Lates special offer – £3 per ride. Corporate Members go free.

SIMULATOR

TAKE CONTROL IN OUR 360° FLIGHT SIMULATOR

19.15-21.10

Have you ever wanted to fly your own jet? Our Fly 360° interactive flight simulators allow you to do just that.

Lates special offer – £10 per ride. Corporate Members get 20% discount.

FOOD + DRINK



SHAKE BAR

Our famous ice cream milkshakes are made to order with Baileys, Kahula or sweet boosts. Or enjoy any of our ten delicious flavours of ice cream, served in cones or cups with toppings of your choice. Beer and cider available as well.

FUTURES LATES

SEXUALITY

27 JUNE 2018

The Science Museum will be collaborating with Pride in London for the next Lates to bring you an LGBTQ+ inspired evening featuring live performance, talks, music, and much more. Join our Drag Kings and Queens around the piano, in a make-up masterclass and join in the drag race! Test your skills in our genital drawing competition, and find out about Polari in our Literary Salon and much more.

FUTURE EVENTS

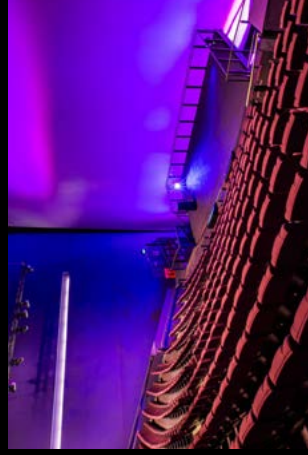

BLACK PANTHER + PANEL DISCUSSION

23 JUNE 2018

TICKETS – £5 ADULT, £3 CONCESSION

Join us at the Science Museum IMAX on 23 July to celebrate International Women in Engineering Day and the Year of Engineering 2018 with a special screening of Marvel's record-breaking blockbuster film, Black Panther.

Set in the mysterious African Republic of Wakanda, the film introduces a new Marvel character – engineering whizz Shuri, aka Princess of Wakanda.

Joining us on the evening will be some real world female engineering superheroes discussing how close real-life tech is to the world of Marvel – and how big screen representation can influence career choice.



PRIDE VARIETY SHOW

27 JUNE 2018

19.30-20.30

TICKETS – £6 EARLY BIRD, £8 AFTER

The legendary Mizz Kimberley, plus special guests (to be announced soon), come together to perform a one-off Pride in London variety show exclusively for the Science Museum's Sexuality Lates.

With energising performances by some of the most talented and beloved acts from within the LGBT community, you can expect to be wowed by this special event in the IMAX Theatre, hosted by the one and only cabaret sensation and Pride in London drag royalty Michael 'twaits.



SEXUALITY LATES AFTERPARTY

27 JUNE 2018

22.00-23.45

TICKETS – £6 EARLY BIRD, £8 AFTER

The Science Museum and Pride in London combine forces to host the first ever Lates Afterparty.

This is your chance to carry on the party with first-class DJs Jay Jay Revlon and Michelle Manetti.

Jay Jay, co-founder of English Breakfast London and father of the Kiki House of Tea, and Michelle, one of London's most established DJs on the East London underground queer scene, together promise to get you onto the dance floor... you don't want to miss out!



FREE WIFI

Available throughout the museum.

ATM

An ATM is located between the Shop and the Energy Café.

TOILETS/ CLOAKROOM

Toilets are located on levels -1, 0, 1, 2 and 3. A cloakroom is available on level 0.

#SMLATES

If you're talking about Lates on Twitter, please use #smlates to help others find your opinions, photos and videos.

SHOP

Whether you're keen on chemistry, ecstatic about mathematics or just want a memento of your day, you'll find something you love in one of our museum shops. We sell a wide range of gifts, toys, books and homeware alongside traditional museum favourites, at a price to suit every budget.

Visit us on level 0 or shop online at sciencemuseumshop.co.uk

DONATIONS

Help us to make the most of our unrivalled collections, acquire new objects, create innovative exhibitions, and continue to deliver the UK's most engaging museum learning programme by donating today.

Donate in the museum or online at sciencemuseum.org.uk

Every pound you give supports our work as a charity. With Gift Aid you can make your donation go further.

Cover image © ESA/Hubble & NASA
All other images © The Board of Trustees of the Science Museum except where stated
Information correct at time of printing

KEEP IN TOUCH

Sign up to our email newsletters at sciencemuseum.org.uk to be the first to hear about the museum's upcoming events and activities.

We love seeing our visitors' photos online. Share yours with @sciencemuseum for the chance to be featured on our channels.



We're always looking to improve our service. If you have any comments or suggestions please email us at info@sciencemuseum.ac.uk

CONTACT INFORMATION

Science Museum
Exhibition Road
London SW7 2DD

sciencemuseum.org.uk
T +44 (0)20 7942 4000
E info@sciencemuseum.ac.uk

OUR GROUP

We are part of the Science Museum Group, which also includes: National Science and Media Museum, Bradford, Museum of Science and Industry, Manchester, National Railway Museum, York, and Locomotion, Shildon.

SCIENCE MUSEUM GROUP